

State of South Carolina

Pursuant to a warrant from John Tho. Esq. Commissioner of Locations dated the 17<sup>th</sup> day of July 1784 I have admeasured & laid out unto John Dewberry a tract of land containing one hundred and fifty acres, situate in Ninety Six District East of the old Indian Boundary on both sides of Tricketty creek of the Broad River bounding N.W. S.W. & S.E. on S. by John Dewberry's land all other sides on Vacant Land and hath such shape and marks as the annexed Plat Represents  
 Surveyed the 23<sup>rd</sup> day of Aug. 1784  
 Recorded the 10<sup>th</sup> day of Nov. 1784

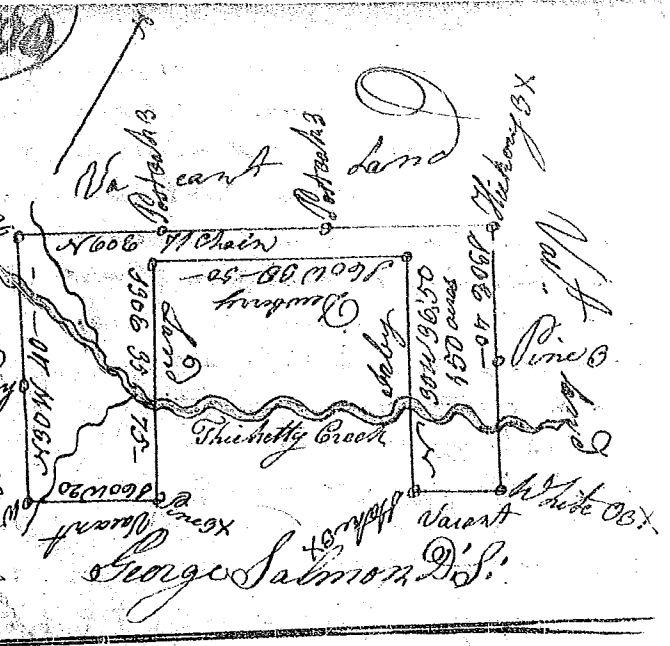

State of South Carolina

Pursuant to a warrant from John Thomas Esq. Commissioner of Locations dated the 21<sup>st</sup> day of July 1784 I have admeasured & laid out unto John Haden a tract of land containing four hundred acres, situate in Ninety Six District East of the old Indian Boundary on both sides of Tricketty creek of Broad River near the head branch bounding N.E. on Malachi Jones all other sides Vacant & hath such shape and marks as the annexed Plat Represents  
 Surveyed the 20<sup>th</sup> day of Aug. 1784  
 Recorded the 10<sup>th</sup> day of Nov. 1784



State of South Carolina

Pursuant to a warrant from John Thomas Esq. Commissioner of Locations dated 6<sup>th</sup> Aug. 1784, I have admeasured and laid out unto John Gowin a tract of two hundred and thirty nine acres of land situate in Ninety Six District on both sides the ancient boundary on South Carolina side bounding on all sides on Vacant Land, and hath such shape as the annexed Plat Represents  
 Surveyed the 10<sup>th</sup> day Aug. 1784  
 Recorded 11<sup>th</sup> Nov. 1784

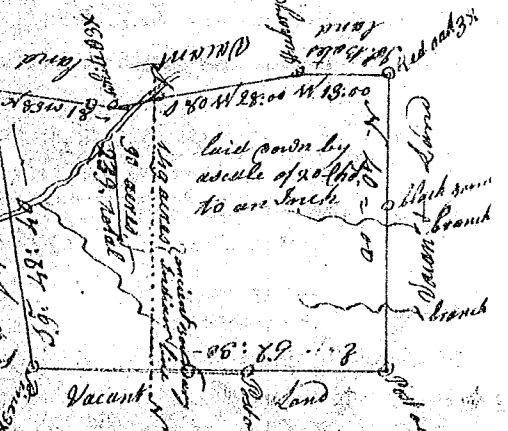

State of South Carolina

Pursuant to a warrant from John Tho. Esq. Commissioner of Locations in 96<sup>th</sup> District N.E. Saluda River dated the 24<sup>th</sup> day of May 1784 I have admeasured & laid out unto Davis Hensley a tract of land containing 101 acres, on the Indian Boundary bounded S. on land laid out to Hensley by Bonden Esq. N.E. on survey land S. on land laid out to all other sides on Vacant Land & hath such shape & marks as the annexed Plat Represents  
 Surveyed the 11<sup>th</sup> July 1784  
 Recorded the 11<sup>th</sup> Nov. 1784

